

2015

Poltech

PT4

STRIPPER CRIMPER

Concise machine manual

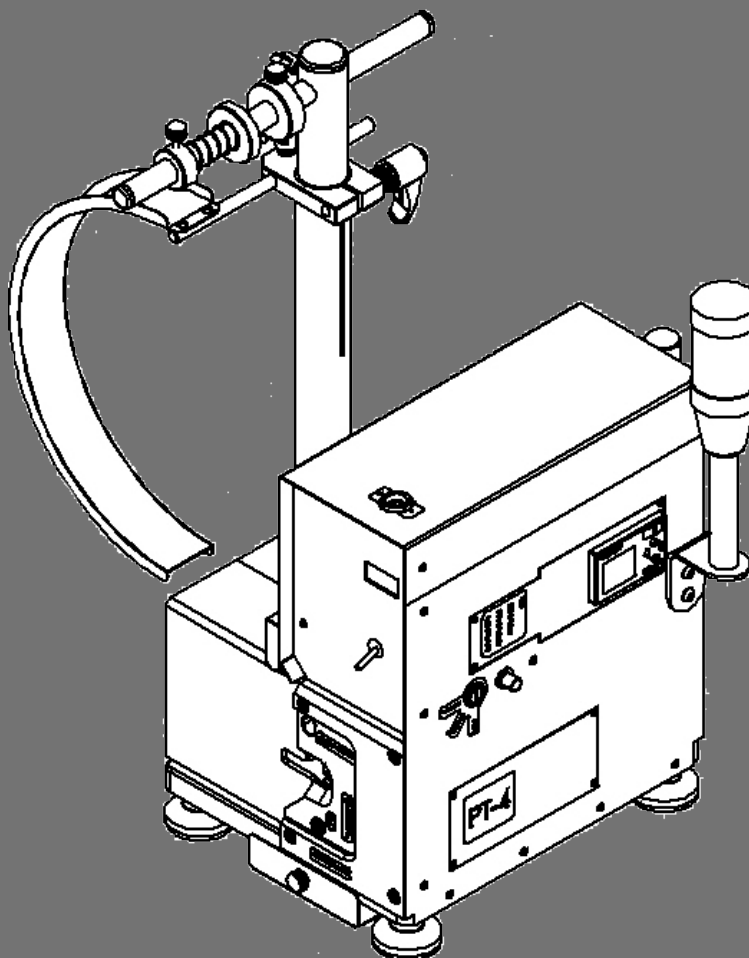

Radek Polcer
POLTECH cz s.r.o.
1.1.2015



1. General description of the machine	3
2. Technical data.....	5
3. Assembly of the machine.....	6
4. Launching the machine.....	7

General description of the machine

Crimping machine PT4 is a pneumatic press controlled LOGO SIEMENS. The press is entirely designed to an application of contacts to a cable and to strip of the cable insulation.

The machine can be extended only by original tools or tools previously used and approved for machines PP3.

The machine is controlled by a unit LOGO SIEMENS that ensures steady and safe running. It is possible to set and impact the running on this unit. It is described in a separate manual.

The whole machine is covered by metal covering and also by covering from pure plexiglass. Under the metal covering there are mechanical, pneumatic and electrical elements to which only the authorised and personnel has the access. The plexiglass covers the tool itself. This can be removed by an operator in order to adjust. All covers must be in place before the machine is turned on.

The machine is powered a 220V wall socket via the built –in adapter by safe voltage 24V.

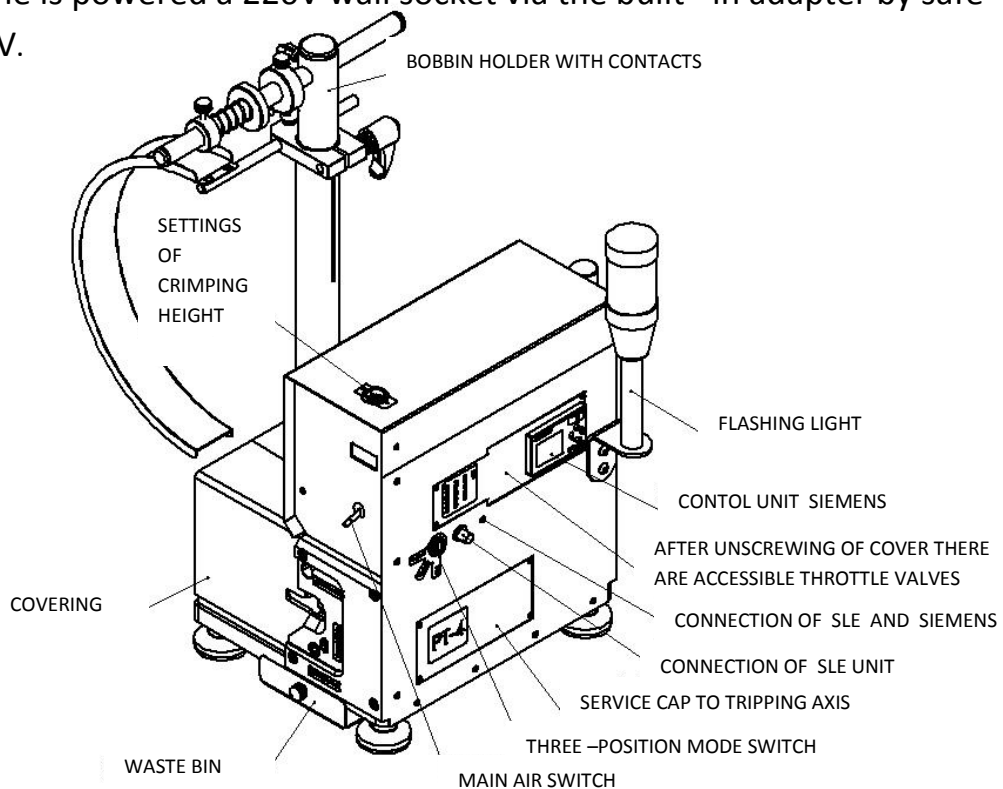

General description of the machine

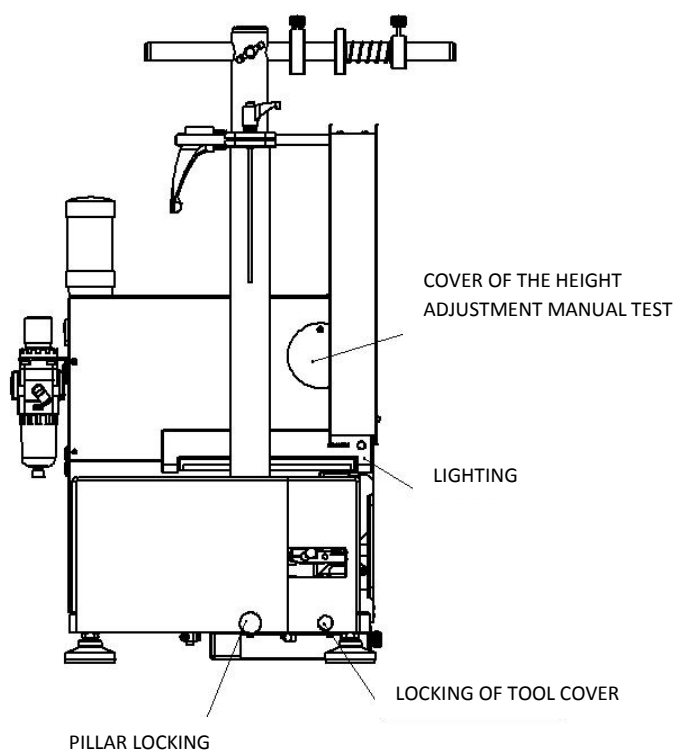
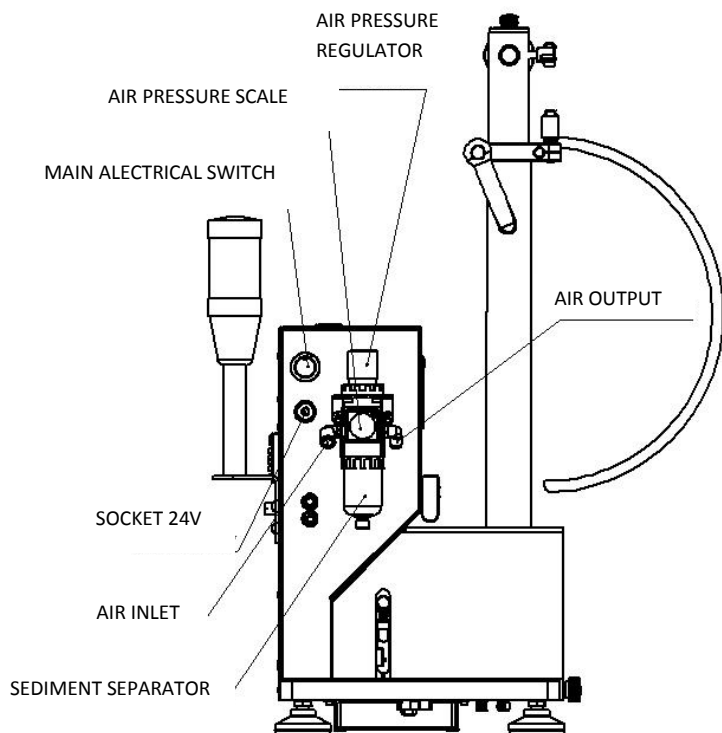

Conductor cross-sections	0,05-1,5mm ²	AWG 30-16	
Min stripping length	0,8mm	0,5mm	
	standard	special blades	
Max stripping length	12mm		
Min unjacketing length	15mm		
Machine cycle	1,2 s		
Productivity	2500pcs/hour		
Air pressure - inlet	10 bar max		
Air pressure - machine	4 – 6 bar		
Mechanical stroke	30mm		
Crimping height scale	5mm	0,04 mm	
	range	division	
Scale of cable-contact position	10mm	0,05mm	
	range	division	
Counter	Digital	Daily	Fully
		resettable	unresettable
Lighting	LEDs		
Veight	14,6kg		
Safety, directive	CE		

Packing the machine

The machine itself is divided and packed into two boxes. Accessories are also packed in the box.

All the components packed in this way are stored in a plastic box which is sent to a customer.

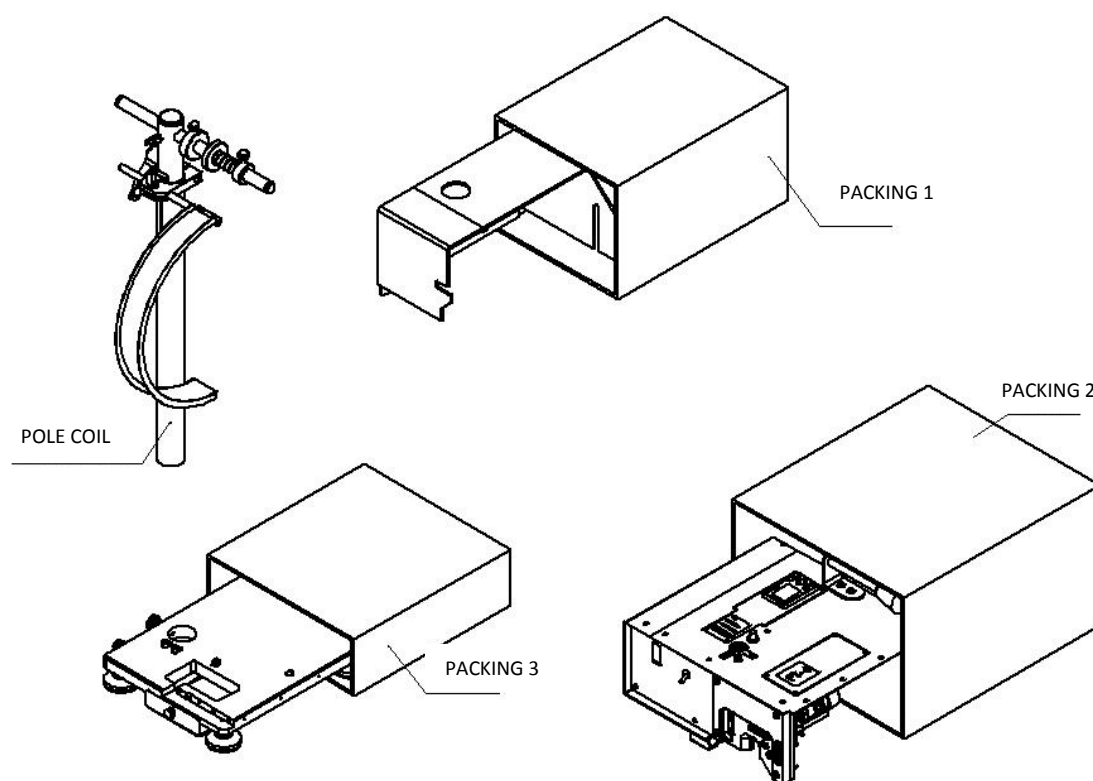

The machine is decomposed for transportation into several parts. Their assembly is not difficult and needed tools for assembly are also supplied.

The assembly procedures:

1. Disassembling of the front cover with screws M5x12 (4x)
2. Removing the screws M5x10 (4x) under the front cover
3. Fitting the body machine to the baseplate
4. Fitting the screws M5x10 (4x) and do not tighten
5. Fitting the screws M3x6 (4x) and do not tighten
6. Tightening of all screws form paragraphs 4 a 5
7. Putting on the front cover
8. Fitting screws M5x12 (4x) slightly tighten
9. Rotating of the flashing light to the position as shown in the picture
10. Mounting the safety cover
11. Mounting the bobbin holder
12. Fixing the safety cap and bobbin holder with locking screws
13. Done

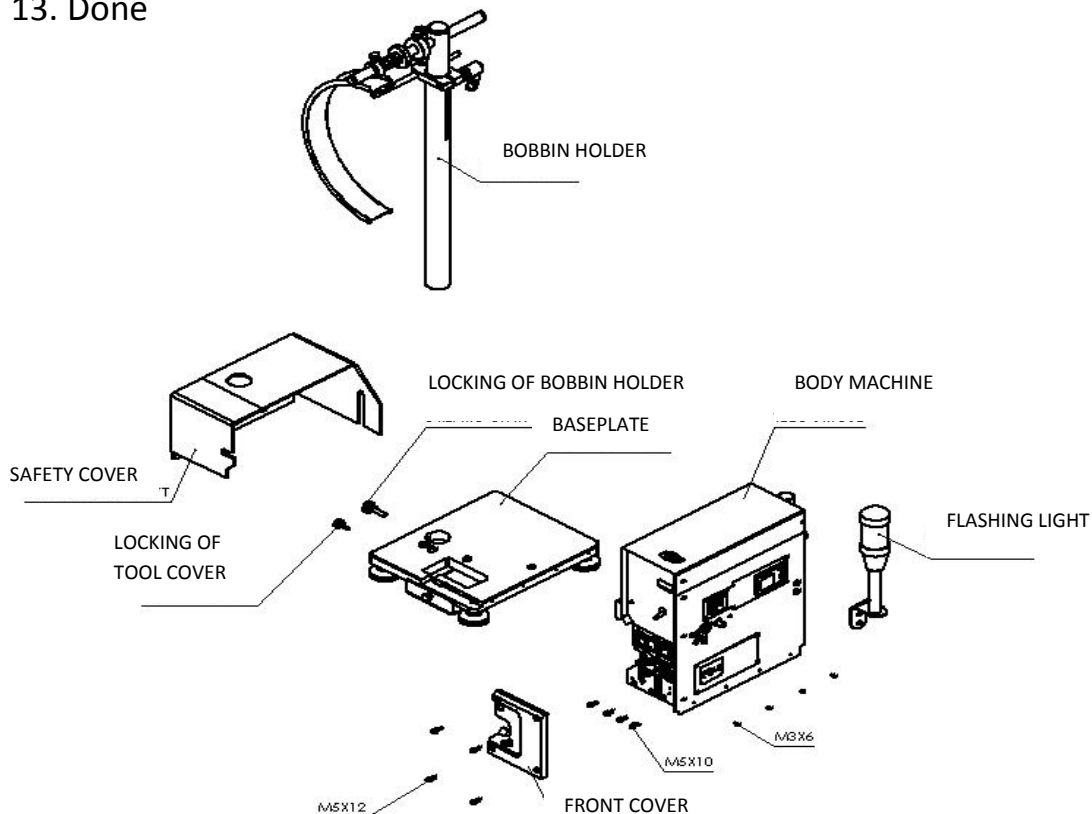

For a successful launch the machine it is necessary to connect the machine to the air distribution systém and power supply 220V.

The machine is connected to air distribution systém by a spiral hose pr.8mm diameter. The hose is mounted by ISO ending on one side. The other side is without ending and it is to be connected to the inlet connection of the air machine. Pressure is set in range of 5-6 bar. After connection of air there is heard weak air leakage which flow to the switching target.

The machine is connected to electrical network by a supplied adapter 220V/24V. A jack connector is connected to the plug on the machine and the plug to the power network 220V. All the electrical equipment of the machine is activated by pressing the main electrical switch.

At this stage the machine is powered but inactivated (the cycle cannot run) it is safe. It is possible to make adjustments on the control unit and safely set the mechanical parts of the machine.

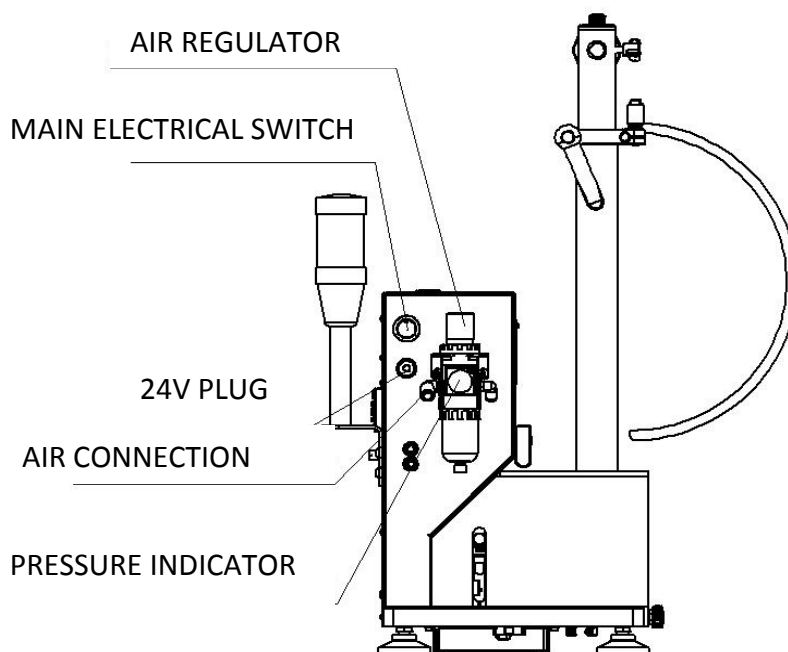

After the switching the main air switch into the position 1 , the whole system is pressurized and all the mechanical elements are moved to the starting position. At this stage it is forbidden to adjust or otherwise interfere in to the space under the cover.

The required working mode is selected by the three position switch:

1. STRIPPING – only the stripping axes is activated (it is used by adjustment of stripping).
2. CRIMPING – the stripping and crimping axis are activated (normal mode of stripping and crimping without measurements).
3. MEASUREMENT – active are crimping axis, stripping axis, shearing blade of defective and measurement of crimp force (crimping mode with tracking the crimp force. In case of a bad crimp the cable is cut off).

